

Eco-Modul 70 modular Signal tower

- Ø 70 mm modular signal tower series
- Complete range of high-luminosity LED light modules with steady/flashing/strobe/multi-strobe beacon functions, 6 different lens colours
- High-performance steady/strobe/multi-strobe beacon modules
- Alternatively operated with conventional incandescent bulb technology
- Piezo buzzer and multi-tone alarm sounder modules available
- Pre-assembled towers or individual tower modules available for configuration
- Extensive range of mounting types
- User-friendly connection technology
- PLC-suitable
- High degree of protection IP66, UL type 4/4X/13

TECHNICAL DATA

| | |
|----------------------------|------------------------------------------------------------------------------------------------------------------------------------------------------------------------|
| Housing | Ø 70 mm, Polycarbonate black |
| Lens | Polycarbonate, ribbed inside orange, red, clear, blue, green or yellow |
| Type of mounting | any |
| Connection technology | up to 2,5mm ² / 14 AWG |
| Leakage current | > 0,003 A (PLC-suitable) |
| Beacon type | LED steady beacon, LED flashing beacon, LED strobe beacon, HP LED steady beacon, HP LED strobe beacon, HP LED multi strobe beacon or Steady beacon (incandescent bulb) |
| Light source | 12 LEDs, 4 high-power LEDs, incandescent bulb |
| Strobe/flash frequency | Flashing beacon 2 Hz, strobe beacon 1.4 Hz, multi strobe beacon 1-2.6 Hz |
| Tone | Steady tone or Pulsing tone |
| Volume | 100 dB |
| Tone frequency | 500-2.700 Hz |
| Duty cycle | 100 % |
| Service life | Light source: LED 100,000 hours, HP LED 50,000 hours |
| Number of possible modules | max. 5, with double bracket max. 10 |
| Operating temperature | -30 °C / +60 °C |
| Degree of protection | IP66 & UL Type 4/4X/13 |
| Weight (modules) | 72-102 g |



Eco-Modul 70 Pre-configured Signal towers



Modular



Order number: ECO70-Q01
Colours: red/orange/green
Function: LED steady beacon
Nominal voltage: 24 V AC/DC
Type of mounting: Tube mounting
 (100 mm tube length)



Order number: ECO70-Q02
Colours: red/green
Function: LED steady beacon
Nominal voltage: 24 V AC/DC
Type of mounting: Tube mounting
 (100 mm tube length)



Order number: ECO70-Q05
Colours: red/orange/green/blue
Function: LED steady beacon
Nominal voltage: 24 V AC/DC
Type of mounting: Tube mounting
 (100 mm tube length)



Order number: ECO70-Q31
Colours: red/orange/green
Function: LED steady beacon, buzzer
 steady or pulsing tone
Nominal voltage: 24 V AC/DC
Type of mounting: Tube mounting
 (100 mm tube length)



Order number: ECO70-Q81
Colours: red/orange/green
Function: LED steady beacon, buzzer
 steady or pulsing tone
Nominal voltage: 230 V AC
Type of mounting: Tube mounting
 (100 mm tube length)

Eco-Modul 70

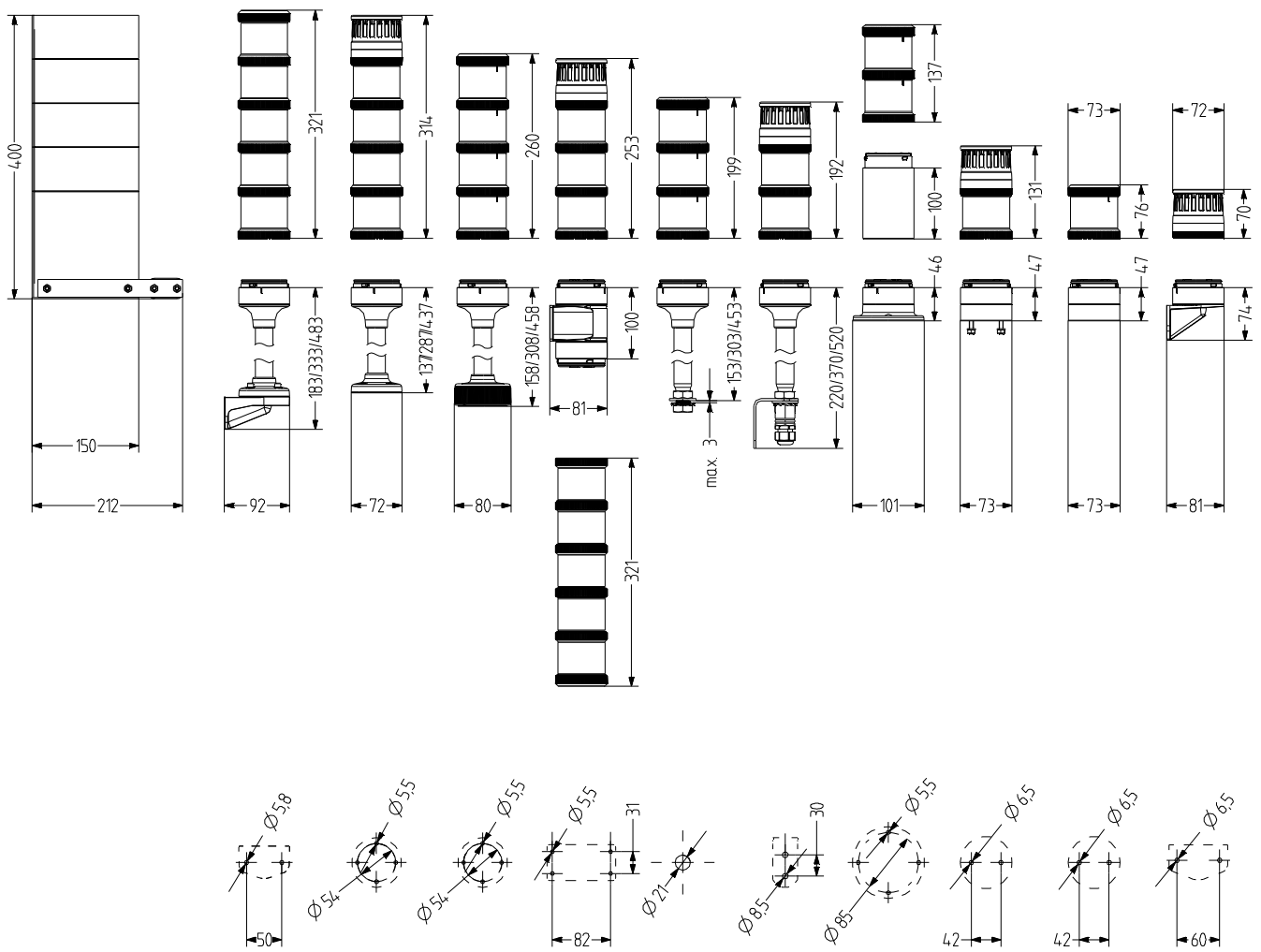

Eco-Modul 70



Modular

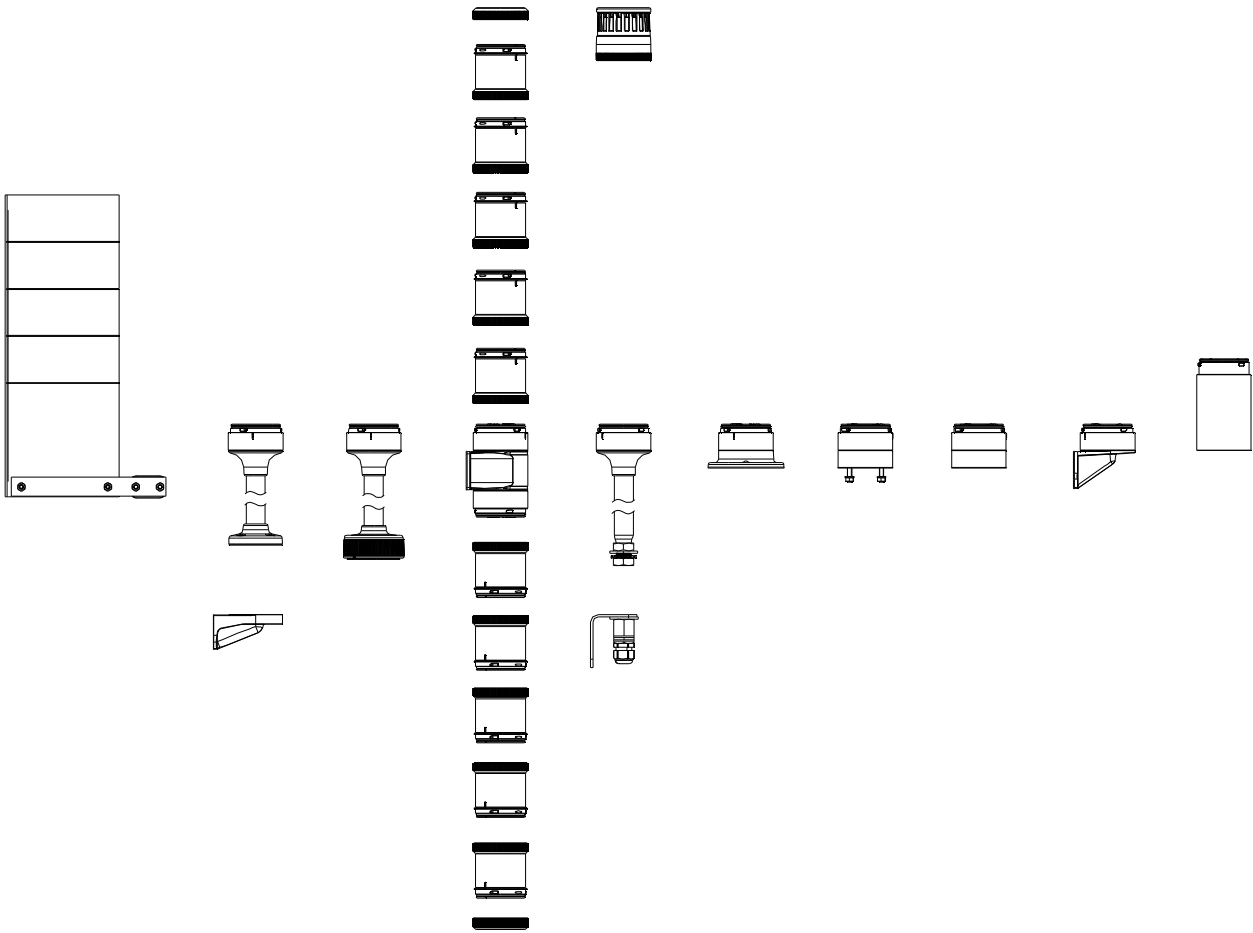

Eco-Modul 70

VISUAL MODULES

| Type | Beacon type | Lens colour | Nominal voltage | Voltage range (V) | Nominal current (A) | Order number | | |
|--------------|---------------------|-------------|-------------------|-------------------|---------------------|--------------|-------------|-------------|
| XLL | Steady beacon | orange | 12-250 V AC/DC | | 7 W | 900 001 900 | | |
| | | red | 12-250 V AC/DC | | 7 W | 900 002 900 | | |
| | | clear | 12-250 V AC/DC | | 7 W | 900 004 900 | | |
| | | blue | 12-250 V AC/DC | | 7 W | 900 005 900 | | |
| | | green | 12-250 V AC/DC | | 7 W | 900 006 900 | | |
| | | yellow | 12-250 V AC/DC | | 7 W | 900 007 900 | | |
| | | XDC | LED steady beacon | orange | 24 V AC/DC | +/- 10 % | 0,049-0,054 | 900 011 405 |
| 110-120 V AC | +/- 10 % | | | | 0,028-0,031 | 900 011 310 | | |
| 230-240 V AC | +/- 10 % | | | | 0,027-0,028 | 900 011 313 | | |
| red | 24 V AC/DC | | | +/- 10 % | 0,049-0,054 | 900 012 405 | | |
| | 110-120 V AC | | | +/- 10 % | 0,028-0,031 | 900 012 310 | | |
| | 230-240 V AC | | | +/- 10 % | 0,027-0,028 | 900 012 313 | | |
| clear | 24 V AC/DC | | | +/- 10 % | 0,049-0,054 | 900 014 405 | | |
| | 110-120 V AC | | | +/- 10 % | 0,028-0,031 | 900 014 310 | | |
| | 230-240 V AC | | | +/- 10 % | 0,027-0,028 | 900 014 313 | | |
| blue | 24 V AC/DC | | | +/- 10 % | 0,049-0,054 | 900 015 405 | | |
| | 110-120 V AC | | | +/- 10 % | 0,028-0,031 | 900 015 310 | | |
| | 230-240 V AC | | | +/- 10 % | 0,027-0,028 | 900 015 313 | | |
| green | 24 V AC/DC | | | +/- 10 % | 0,049-0,054 | 900 016 405 | | |
| | 110-120 V AC | | | +/- 10 % | 0,028-0,031 | 900 016 310 | | |
| | 230-240 V AC | | | +/- 10 % | 0,027-0,028 | 900 016 313 | | |
| yellow | 24 V AC/DC | | | +/- 10 % | 0,049-0,054 | 900 017 405 | | |
| | 110-120 V AC | | | +/- 10 % | 0,028-0,031 | 900 017 310 | | |
| | 230-240 V AC | | | +/- 10 % | 0,027-0,028 | 900 017 313 | | |
| XDA | LED flashing beacon | | | orange | 24 V AC/DC | +/- 10 % | 0,058 | 900 021 405 |
| | | | | | 110-120 V AC | +/- 10 % | 0,028-0,030 | 900 021 310 |
| | | | | | 230-240 V AC | +/- 10 % | 0,030-0,031 | 900 021 313 |
| | | | | red | 24 V AC/DC | +/- 10 % | 0,058 | 900 022 405 |
| | | | | | 110-120 V AC | +/- 10 % | 0,028-0,030 | 900 022 310 |
| | | | | | 230-240 V AC | +/- 10 % | 0,030-0,031 | 900 022 313 |
| | | | | clear | 24 V AC/DC | +/- 10 % | 0,058 | 900 024 405 |
| | | | | | 110-120 V AC | +/- 10 % | 0,028-0,030 | 900 024 310 |
| | | | | | 230-240 V AC | +/- 10 % | 0,030-0,031 | 900 024 313 |
| | | blue | 24 V AC/DC | +/- 10 % | 0,058 | 900 025 405 | | |
| | | | 110-120 V AC | +/- 10 % | 0,028-0,030 | 900 025 310 | | |
| | | | 230-240 V AC | +/- 10 % | 0,030-0,031 | 900 025 313 | | |
| | | green | 24 V AC/DC | +/- 10 % | 0,058 | 900 026 405 | | |
| | | | 110-120 V AC | +/- 10 % | 0,028-0,030 | 900 026 310 | | |
| | | | 230-240 V AC | +/- 10 % | 0,030-0,031 | 900 026 313 | | |
| | | yellow | 24 V AC/DC | +/- 10 % | 0,058 | 900 027 405 | | |
| | | | 110-120 V AC | +/- 10 % | 0,028-0,030 | 900 027 310 | | |
| | | | 230-240 V AC | +/- 10 % | 0,030-0,031 | 900 027 313 | | |

Eco-Modul 70

VISUAL MODULES

| Type | Beacon type | Lens colour | Nominal voltage | Voltage range (V) | Nominal current (A) | Order number | | |
|--------|-------------------------|-------------|-------------------|--------------------------|---------------------|--------------------------|-----------|-------------|
| XDF | LED strobe beacon | orange | 24 V AC/DC | +/- 10 % | 0,130-0,135 | 900 031 405 | | |
| | | | 110-120 V AC | +/- 10 % | 0,010 | 900 031 310 | | |
| | | | 230-240 V AC | +/- 10 % | 0,010 | 900 031 313 | | |
| | | red | 24 V AC/DC | +/- 10 % | 0,130-0,135 | 900 032 405 | | |
| | | | 110-120 V AC | +/- 10 % | 0,010 | 900 032 310 | | |
| | | | 230-240 V AC | +/- 10 % | 0,010 | 900 032 313 | | |
| | | clear | 24 V AC/DC | +/- 10 % | 0,130-0,135 | 900 034 405 | | |
| | | | 110-120 V AC | +/- 10 % | 0,010 | 900 034 310 | | |
| | | | 230-240 V AC | +/- 10 % | 0,010 | 900 034 313 | | |
| | | blue | 24 V AC/DC | +/- 10 % | 0,130-0,135 | 900 035 405 | | |
| | | | 110-120 V AC | +/- 10 % | 0,010 | 900 035 310 | | |
| | | | 230-240 V AC | +/- 10 % | 0,010 | 900 035 313 | | |
| | | green | 24 V AC/DC | +/- 10 % | 0,130-0,135 | 900 036 405 | | |
| | | | 110-120 V AC | +/- 10 % | 0,010 | 900 036 310 | | |
| | | | 230-240 V AC | +/- 10 % | 0,010 | 900 036 313 | | |
| | | yellow | 24 V AC/DC | +/- 10 % | 0,130-0,135 | 900 037 405 | | |
| | | | 110-120 V AC | +/- 10 % | 0,010 | 900 037 310 | | |
| | | | 230-240 V AC | +/- 10 % | 0,010 | 900 037 313 | | |
| | | XDC-HP | LED steady beacon | orange | 24 V AC/DC | 18-36 V AC 18-30 V DC | 0,170-0,2 | 900 051 405 |
| | | | | red | 24 V AC/DC | 18-36 V AC 18-30 V DC | 0,170-0,2 | 900 052 405 |
| | | | | clear | 24 V AC/DC | 18-36 V AC 18-30 V DC | 0,170-0,2 | 900 054 405 |
| blue | 24 V AC/DC | | | 18-36 V AC 18-30 V DC | 0,170-0,2 | 900 055 405 | | |
| green | 24 V AC/DC | | | 18-36 V AC 18-30 V DC | 0,170-0,2 | 900 056 405 | | |
| yellow | 24 V AC/DC | | | 18-36 V AC 18-30 V DC | 0,170-0,2 | 900 057 405 | | |
| XDF-HP | LED strobe beacon | orange | 24 V AC/DC | 18-36 V AC 18-30 V DC | 0,26-0,265 | 900 061 405 | | |
| | | red | 24 V AC/DC | 18-36 V AC 18-30 V DC | 0,26-0,265 | 900 062 405 | | |
| | | clear | 24 V AC/DC | 18-36 V AC 18-30 V DC | 0,26-0,265 | 900 064 405 | | |
| | | blue | 24 V AC/DC | 18-36 V AC 18-30 V DC | 0,26-0,265 | 900 065 405 | | |
| | | green | 24 V AC/DC | 18-36 V AC 18-30 V DC | 0,26-0,265 | 900 066 405 | | |
| | | yellow | 24 V AC/DC | 18-36 V AC 18-30 V DC | 0,26-0,265 | 900 067 405 | | |
| XFF-HP | LED multi strobe beacon | orange | 24 V AC/DC | 18-36 V AC 18-30 V DC | 0,26-0,265 | 900 071 405 | | |
| | | red | 24 V AC/DC | 18-36 V AC 18-30 V DC | 0,26-0,265 | 900 072 405 | | |
| | | clear | 24 V AC/DC | 18-36 V AC 18-30 V DC | 0,26-0,265 | 900 074 405 | | |
| | | blue | 24 V AC/DC | 18-36 V AC 18-30 V DC | 0,26-0,265 | 900 075 405 | | |
| | | green | 24 V AC/DC | 18-36 V AC 18-30 V DC | 0,26-0,265 | 900 076 405 | | |
| | | yellow | 24 V AC/DC | 18-36 V AC 18-30 V DC | 0,26-0,265 | 900 077 405 | | |



Modular

Eco-Modul 70

AUDIBLE MODULES

| Type | Tone | Volume | Nominal voltage | Voltage range (V) | Nominal current (A) | Order number |
|------|----------------------------------------------------------------------------------------|---------------------------------------------|-----------------|-------------------|---------------------|--------------|
| XDE | Piezo buzzer module steady tone/pulsing tone | 100 dB (can be adjusted with potentiometer) | 24 V AC/DC | +/- 10 % | 0,092 | 900 500 405 |
| | | | 110-120 V AC | +/- 10 % | 0,041 | 900 500 310 |
| | | | 230-240 V AC | +/- 10 % | 0,043 | 900 500 313 |
| XDZ | Piezo buzzer module steady tone/pulsing tone, 2 tones, tone can be switched externally | 100 dB (can be adjusted with potentiometer) | 24 V AC/DC | +/- 10 % | 0,092 | 900 510 405 |
| | | | 110-120 V AC | +/- 10 % | 0,041 | 900 510 310 |
| | | | 230-240 V AC | +/- 10 % | 0,043 | 900 510 313 |
| XDM | Piezo buzzer module steady tone/pulsing tone, 8 tones | 100 dB (can be adjusted with potentiometer) | 24 V AC/DC | +/- 10 % | 0,311 | 900 520 405 |
| | | | 110-120 V AC | +/- 10 % | 0,045 | 900 520 310 |
| | | | 230-240 V AC | +/- 10 % | 0,043 | 900 520 313 |

ORDER DATA - BASE

| Type | Type of accessory | Tube length | Order number |
|------|---------------------------------------------------------------------------------|-------------|--------------|
| XMW | Base for horizontal mounting M20, inside mounting holes | | 900 570 900 |
| XMS | Base for horizontal mounting with pre-mounted fixing screws | | 900 571 900 |
| XMF | Base for horizontal mounting with external mounting holes | | 900 572 900 |
| XMV | Base for vertical mounting for single-sided mounting | | 900 573 900 |
| XZV | Base for vertical mounting for double-sided mounting | | 900 574 900 |
| XMR | Tube base 100 mm on aluminium tube with plastic foot | 100 mm | 900 582 900 |
| | Tube base 250 mm on aluminium tube with plastic foot | 250 mm | 900 583 900 |
| | Tube base 400 mm on aluminium tube with plastic foot | 400 mm | 900 584 900 |
| XNW | Tube base | | 900 570 950 |
| XSW | Tube base 100 mm on aluminium tube for horizontal mounting with banjo bolt | 250 mm | 900 593 900 |
| | Tube base 250 mm on aluminium tube for horizontal mounting with banjo bolt | 100 mm | 900 592 900 |
| | Tube base 400 mm on aluminium tube for horizontal mounting with banjo bolt | 400 mm | 900 594 900 |
| XFR | Quick mounting system 'foot adapter' 100 mm on aluminium tube with foot adapter | 100 mm | 900 562 900 |
| | Quick mounting system 'foot adapter' 250 mm on aluminium tube with foot adapter | 250 mm | 900 563 900 |
| | Quick mounting system 'foot adapter' 400 mm on aluminium tube with foot adapter | 400 mm | 900 564 900 |



XWR



XSS



XIB



XEP

ACCESSORIES

| Type | Type of accessory | Weight | Order number |
|------|------------------------------------------------------|--------|--------------|
| XWR | Bracket for vertical mounting of TMR/UMR tube base | 95 g | 900 600 900 |
| XSS | Set Set for vertical mounting (bracket, cable gland) | 135 g | 900 700 900 |
| XIB | Identification plate | 235 g | 900 850 900 |
| XEP | Base extension 100 mm long, suitable for all bases | | 900 800 900 |